

### Special Features

- ▲ VANDAL RESISTANT DESIGN
- ▲ HYGIENIC ONE PIECE CONSTRUCTION
- ▲ INTEGRAL RETURN ENDS FOR WALL OR FREE STANDING INSTALLATIONS
- ▲ CONCEALED SPARGE PIPES
- ▲ COMPLETE WITH FLUSHPIPE AND CISTERN
- ▲ EASILY AND QUICKLY INSTALLED AT ADULT OR JUNIOR HEIGHT
- ▲ COMPETITIVELY PRICED
- ▲ OPTIONAL WHITE **Enviro-Glaze** FINISH ON STANDARD LENGTHS

### Description

The trough urinal can be wall mounted at adult or junior height leaving the floor clear for ease of cleaning and hygiene. The wall hung urinal is economically priced, easy to install and can be supplied, as an option, in a white **Enviro-Glaze** finish making it an ideal alternative to traditional ceramic bowl urinals. The product is available in a range of standard and special lengths.



### Construction

The urinal is manufactured in one piece without joints or crevices from grade 304 stainless steel, with all exposed surfaces polished to a satin finish.

The requisite fall to either a right hand or left hand outlet is built into the channel and the back of the urinal is designed to ensure an efficient spread of flushing water without drips or splashing. The urinal back panel is sound deadened to eliminate drumming.

Available in either five standard lengths or special lengths, all urinals incorporate concealed sparge pipes and integral return ends for either wall or free standing installations. Each urinal is supplied with a dome grated waste fitting and automatic cistern and flushpipe.

### Options

- ▲ Corner infill section for 'L' or 'U' plan assembly.
- ▲ End feed and off centre flushpipe connection.
- ▲ Stainless steel automatic cistern (see catalogue section 1 - product code 131).
- ▲ Stainless steel undershroud to conceal waste pipework.
- ▲ White **Enviro-Glaze** finish (available on urinals up to 2400 mm long only).



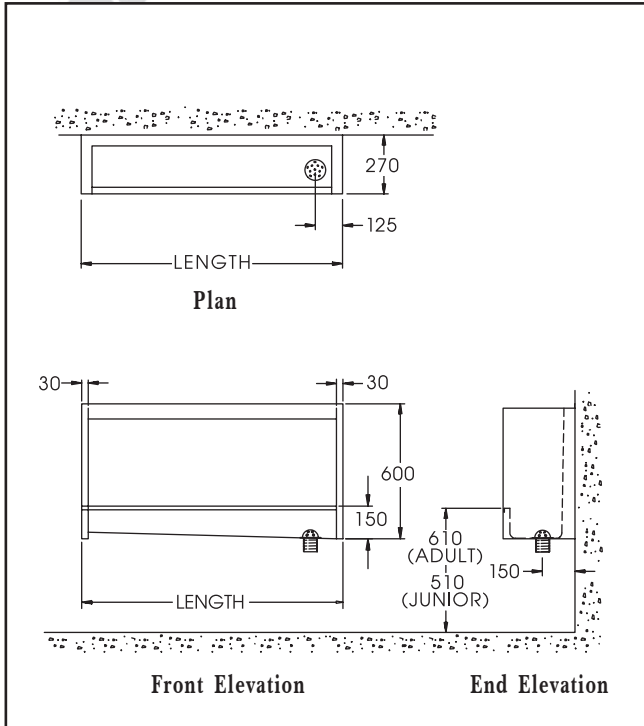

## Length

The urinal is available in five standard lengths; 1200 mm, 1800 mm, 2400 mm, 3000 mm and 3600 mm. Alternatively any special length up to 3600 mm. Lengths over 3600 mm supplied as multiple units with joint cover trim for abutting ends.

## Waste Outlet

All urinals are supplied with a 50 mm (2 in) BSP dome grated waste fitting positioned at either the right hand or left hand end (as viewed facing the unit).

## Flushing System

All urinals are fitted with perforated sparge pipes concealed within the units' construction. The sparge pipe connection to the flushpipe can be top entry for an exposed surface mounted cistern (see Fig. 1) or back entry for a concealed duct mounted cistern (see Fig. 2).

## Flushpipe

Urinals are supplied with 22 mm diameter stainless steel flushpipes and wall fixing clips. The length of each flushpipe allows for its cistern to be mounted at the maximum recommended height.

## Cistern

All urinals are supplied with plastic or optional stainless steel automatic flushing cisterns. Each cistern is complete with lid, syphon and petcock. The recommended mounting height is 1800 mm minimum to 2000 mm maximum from the underside of the cistern to finished floor level.

## Cistern Capacity

Urinal Length	-up to 1200 mm	-1201-3600 mm
Cisterns	-1 x 9.0 litre	-1 x 13.65 litre

## Product Code Selection for Order or Quotation

### 1. Base Product Code

065-wall hung trough urinal

### 2. Length

- 1200       -2400
- 1800       -3000
- 3600
- \_\_\_\_\_ special (specify)

### 3. Outlet (as facing)

-R-right hand     -L-left hand

### 4. Flushing System

- TE-top entry     -BE-back entry
- S-special (supply dimensioned sketch)

### 5. Options

- 131-stainless steel cistern
- JT-joint cover trim
- CS-corner infill section
- RU-removable undershroud
- WG-white **Enviro-Glaze**

